

KODAK Solar Module

P72S09 Series

325-345/SC Series

Poly 345W Module

This time-tested legacy module series has been proven to be one of the powerful and most reliable products offered by Blue Mountain Energy and the most popular choice by PV system installers and customers around world.



5 busbar solar cell design



Anti-PID



Low cost



Highly reliable due to strict quality control

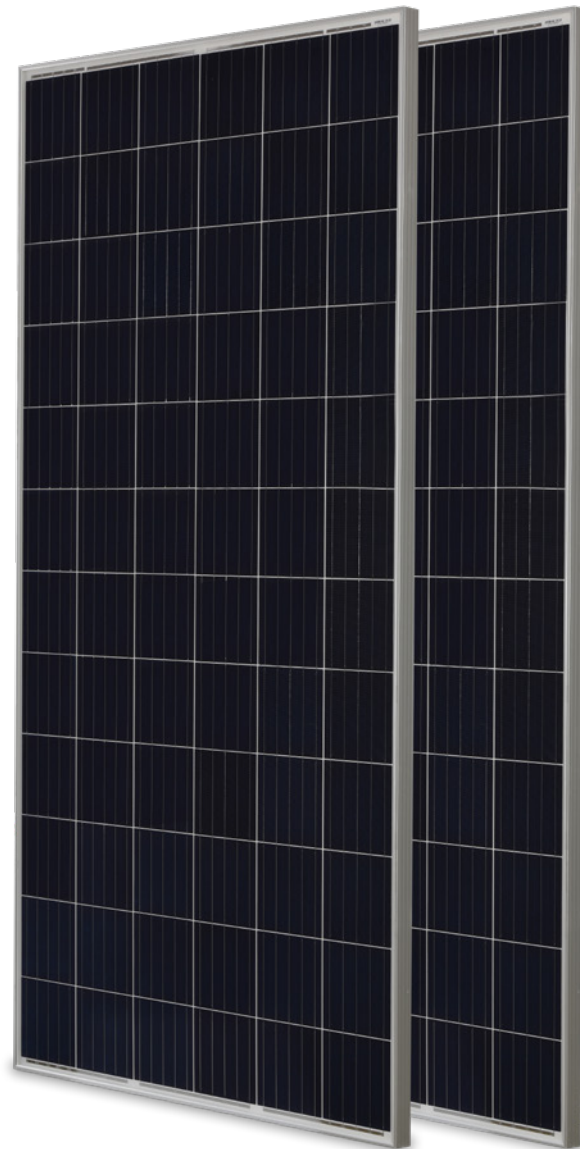

Superior Warranty

- 12-year product warranty
- 25-year linear power output warranty

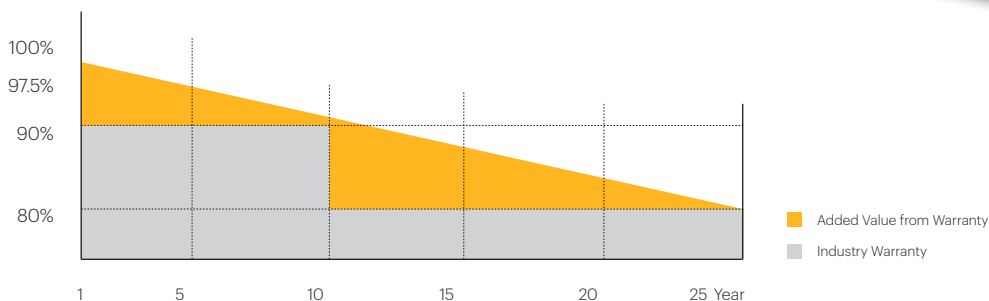

KODAK Solar Module

P72S09 Series

SPECIFICATIONS

Mechanical Diagrams

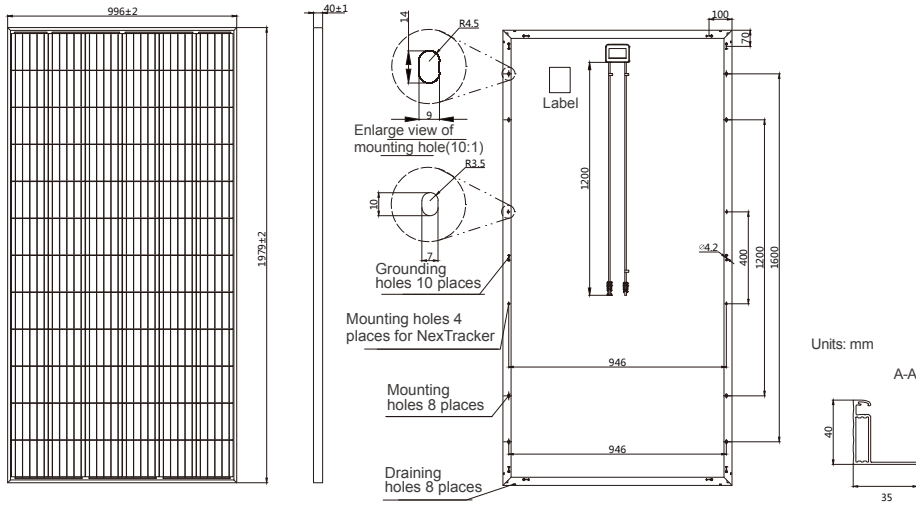

Remark: customized frame color and cable length available upon request

Characteristics

Current-Voltage Curve P72S09-335/SC

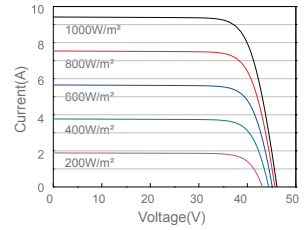

Power-Voltage Curve P72S09-335/SC

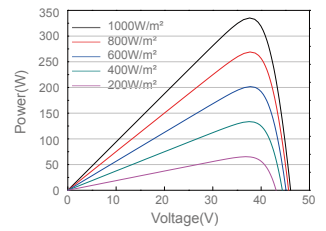

Current-Voltage Curve P72S09-335/SC

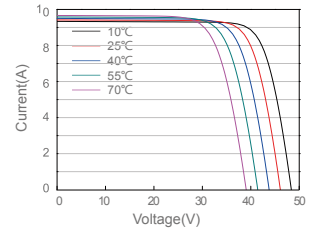

Specifications

Cell	Poly
Weight	22.3kg±3%
Dimensions	1979±2mm×996±2mm×40±1mm
Cable Cross Section Size	4mm²
No. of cells	72(6×12)
Junction Box	IP67, 3 diodes
Connector	QC 4.10(1000V) / QC 4.10-35(1500V)
Packaging Configuration	27 Per Pallet

Operating Conditions

Maximum System Voltage	1000V/1500V DC(IEC)
Operating Temperature	-40°C~+85°C
Maximum Series Fuse	20A
Maximum Static Load,Front	5400Pa
Maximum Static Load,Back	2400Pa
NOCT	45±2°C
Application Class	Class A

Electrical Parameters at STC

MODEL	P72S09-325/SC	P72S09-330/SC	P72S09-335/SC	P72S09-340/SC	P72S09-345/SC
Rated Maximum Power(Pmax) [W]	325	330	335	340	345
Open Circuit Voltage(Voc) [V]	45.56	45.83	46.10	46.39	46.68
Maximum Power Voltage(Vmp) [V]	36.90	37.18	37.45	37.74	38.04
Short Circuit Current(Isc) [A]	9.28	9.35	9.42	9.48	9.55
Maximum Power Current(Imp) [A]	8.81	8.88	8.95	9.01	9.07
Module Efficiency [%]	16.5	16.7	17.0	17.2	17.5
Power Tolerance			0~+5W		
Temperature Coefficient of Isc(α _{Isc})			+0.058%/°C		
Temperature Coefficient of Voc(β _{Voc})			-0.330%/°C		
Temperature Coefficient of Pmax(γ _{Pmp})			-0.400%/		
STC	Irradiance 1000W/m², cell temperature 25°C, AM1.5G				

Remark: Electrical data in this catalog do not refer to a single module and they are not part of the offer. They only serve for comparison among different module types.
 *For NexTracker installations static loading performance: front load measures 2400Pa, while back load measures 2400Pa.

Electrical Parameters at NOCT

MODEL	P72S09-325/SC	P72S09-330/SC	P72S09-335/SC	P72S09-340/SC	P72S09-345/SC
Rated Max Power(Pmax) [W]	240	244	248	252	256
Open Circuit Voltage(Voc) [V]	43.38	43.57	43.77	43.96	44.16
Max Power Voltage(Vmp) [V]	35.17	35.38	35.59	35.81	36.03
Short Circuit Current(Isc) [A]	7.33	7.40	7.47	7.55	7.62
Max Power Current(Imp) [A]	6.82	6.90	6.97	7.04	7.11
NOCT	Irradiance 800W/m², ambient temperature 20°C, wind speed 1m/s, AM1.5G				

Electrical data in this catalog do not refer to a single module and they are not part of the offer. They only serve for comparison among different module types.
 All information contained in this document is subject to change without notice.

